

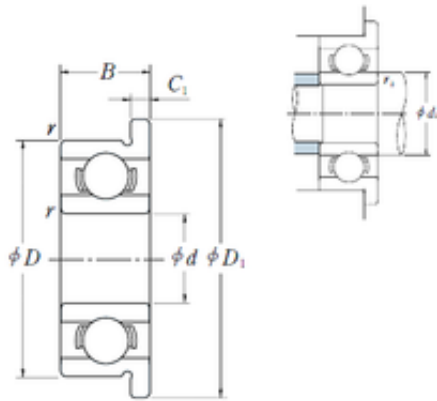

BEARING TYCA PRIVATE LTD.



6 mm x 10 mm x 2,5 mm NSK MF106 deep groove ball bearings

Bearing No. MF106

MF106 Bearing 2D drawings and 3D CAD models

Size	6x11.2x2.5 mm
Bore Diameter	6 mm
Outer Diameter	11,2 mm
Width	2,5 mm
d	6 mm
D	10 mm
D1	11,2 mm
B	2,5 mm
r min.	0,15 mm
C1	0,6 mm
da min.	7,2 mm
ra max.	0,15 mm
Weight	0,65 Kg
Basic dynamic load rating (C)	495 kN
Basic static load rating (C0)	218 kN
(Grease) Lubrication Speed	45000 r/min
SRI	0.67
hidYobi	MF106
LangID	1
D_	10
SREX	0.02
C	0.495
B_	2.5
hidTable	ecat_NSESBMF
C0r	22



BEARING TYCA PRIVATE LTD.

Oil rpm	53000
SRE	0.67
mass	0.65
GRS rpm	45000
ra	0.15
SRIX	0.02
Cr	51
SRIN	0
C_1	0.6
C0	0.218
fo	15.139
SREN	0
D_1	11.2
DE_	9.2
Prod_Type3	ESM_MD_WF_OT
da	7.2
DA_	1.2
Z_	10
yobi	MF106
SDM_	8
r	0.15
KBRG	6102
DI_	6.8
B0	2.5